

# CONNECTION DETAILS

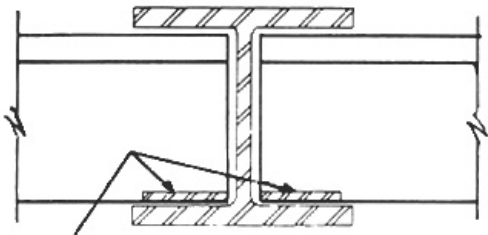

Steel plates cast in Double Tee Stem

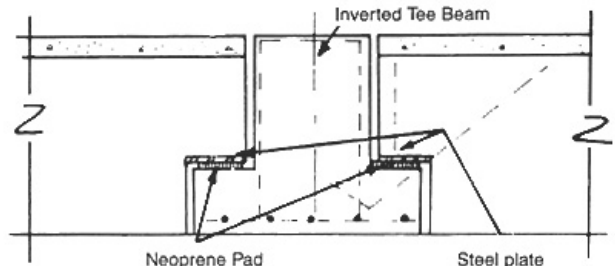

Neoprene Pad

Steel plate cast in stem

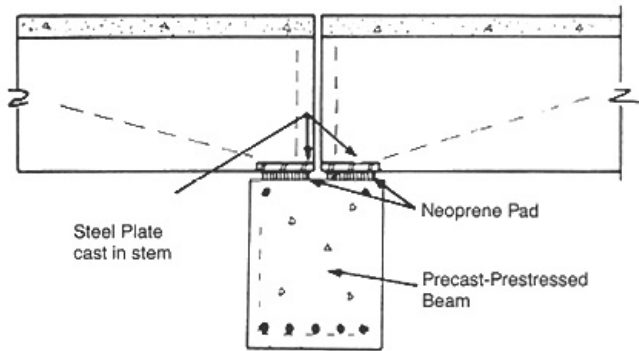

Steel Plate cast in stem

Neoprene Pad

Precast-Prestressed Beam

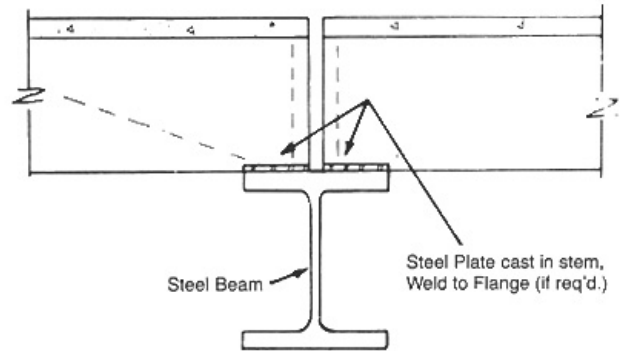

Steel Beam

Steel Plate cast in stem, Weld to Flange (if req'd.)

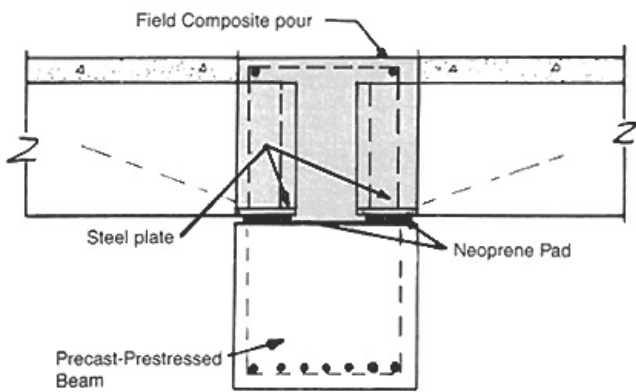

Field Composite pour

Steel plate

Neoprene Pad

Precast-Prestressed Beam

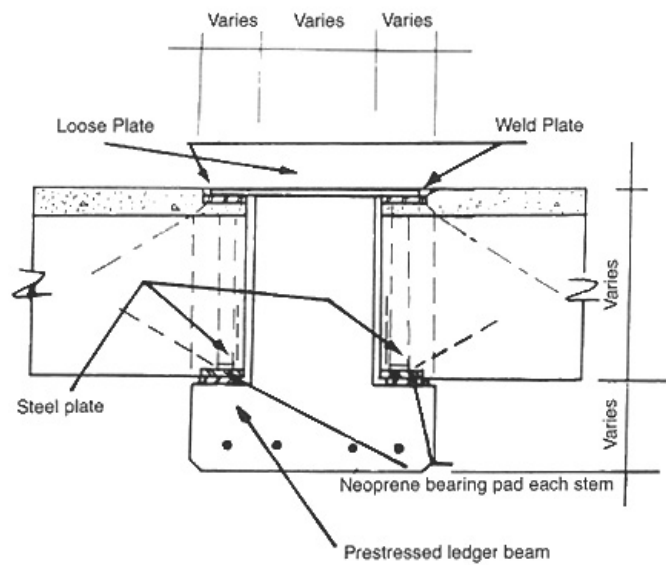

Varies

Varies

Varies

Loose Plate

Weld Plate

Steel plate

Varies

Varies

Neoprene bearing pad each stem

Prestressed ledger beam

**Double Tee to Interior Beam  
For Floor or Roof**

# CONNECTION DETAILS

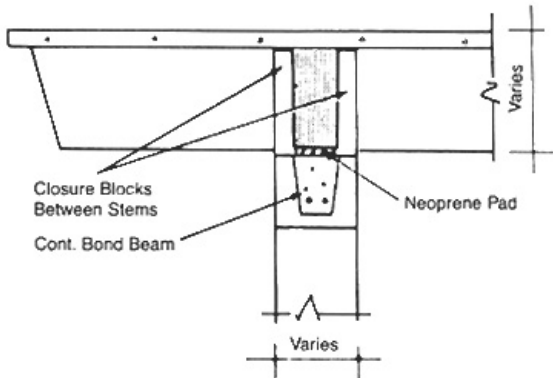

**Cantilevered End-Roof**

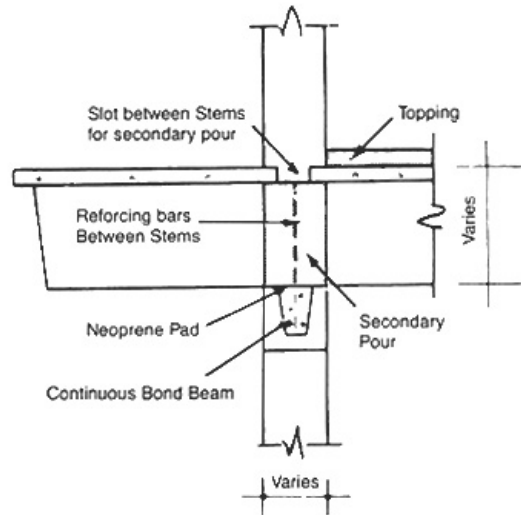

**Cantilevered End-Roof**

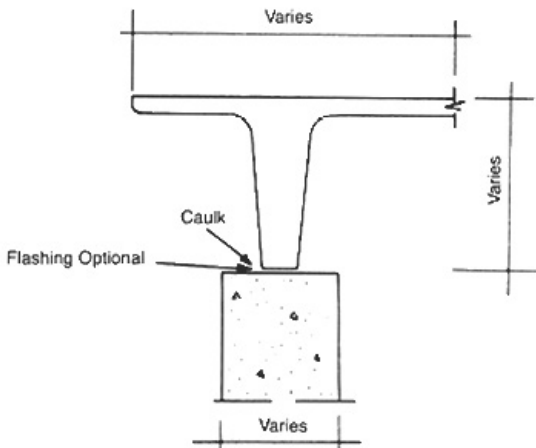

**Sidewall Detail – Roof**

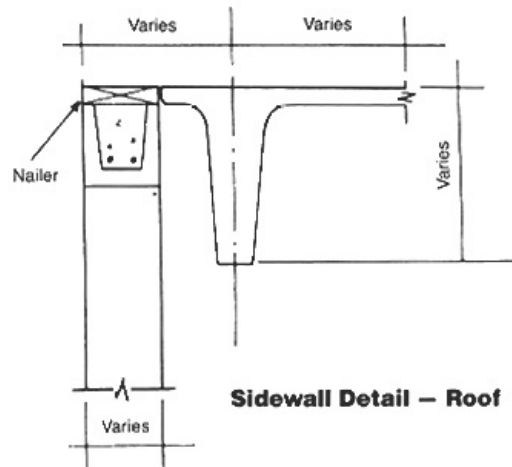

**Sidewall Detail – Roof**

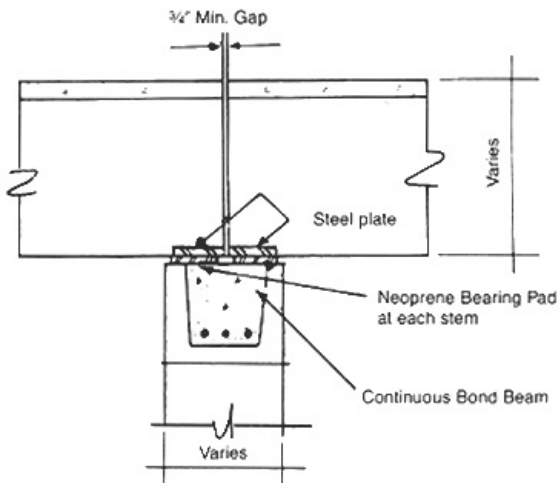

**Double Tee to Interior Wall  
For Floor or Roof**

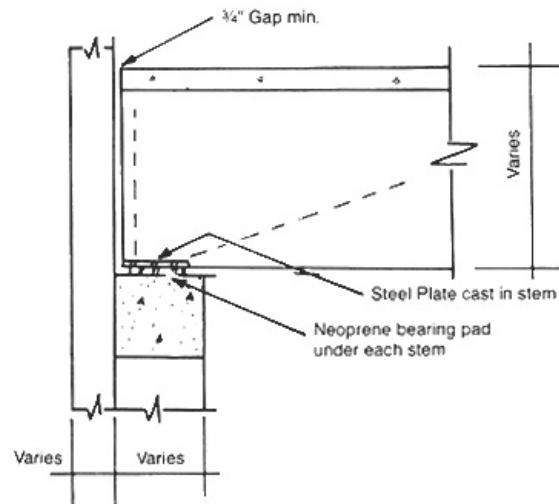

**Sidewall End Bearing Detail  
For Floor or Roof**